

# DUBA PLAINS CAMP

DUBA PLAINS CONCESSION | NORTHERN BOTSWANA

GREAT PLAINS

CONSERVING AND EXPANDING NATURAL HABITATS

ESTABLISHED IN 1991

## The renowned Duba Plains Camp sits in the heart of the Okavango Delta.

A matrix of palm-dotted islands, flood plains and woodland, the 33 000-hectare private reserve is typical of the region's unique landscape. Duba Plains Camp offers 5 bespoke suites, in addition to a separate 2-bedroom suite aptly named the Duba Plains Suite, all designed by Dereck Joubert to blend into the forest and to take advantage of the shapes and textures of the shade but also to evoke the old classic African safari style of the 1920's. It is a wildlife connoisseur's getaway with literally thousands of animals in an almost endless pattern across the flood plains. All the suites are raised on recycled railway sleeper decking and offer guests amazing views of the surrounding floodplain and the steady stream of wildlife parading past.

This is the place that the owners, and National Geographic filmmakers, conservationists and explorers, Dereck and Beverly Joubert, chose for their home base. Great Plains Conservation is the only operator on the concession, thereby offering guests the ultimate opportunity for private wildlife sightings.

Duba Plains has developed a model that creates maximum benefit for the community nearby with lease funds, jobs and other projects like our Big Cats Caring for Communities, Lamps for Learning (solar jars) and Conservation Camp for Kids. This partnership ensures that these communities receive tangible and substantial benefits from wildlife conservation.

Duba Plains prides itself on its extraordinary wildlife experiences and intimate up-close exposure to the best of the best wildlife, from lions and leopards to elephants and buffalo and everything in between. Duba Plains is also known for interesting Kalahari species like Aardwolf and Pangolins.

Each of our camps have executive chefs and a hand-picked wine list. Duba Plains is no exception and boasts a cellar of a few hundred bottles of wine from friends of the Jouberts - winemakers who tell their story beyond the bottle, conservationists, people who have a community they support or something they give back besides being on the Great Plains Wine Selection for the quality of their wines.

While Duba Plains offers Botswana's best land safari as well as an Okavango Delta experience, this is truly a place to find an invigorating, yet peaceful all-round set of experiences, from wildlife viewing and birding or fishing from the boat, mekoro safaris, and exciting drives with knowledgeable guides and friendly hosts.

Duba Plains is a proud member of Relais & Châteaux.





# DUBA PLAINS CAMP

DUBA PLAINS CONCESSION | NORTHERN BOTSWANA

## CAMP FEATURES:

Duba Plains can accommodate a maximum of 10 guests (excluding the Duba Plains Suite)

## Total Number of Bedrooms:

5 Double or twin configuration suites;

Separate 2-bedroom Duba Plains Suite is available for guests to reserve;

1 guide tent with 2 three-quarter beds and a shared en-suite bathroom

## Type of Lodge

Réserve Collection Safari Camp

## Lodge Season & Opening

Year Round

## Ideal length of stay

3 - 4 Nights

## CAMP CO-ORDINATES

19°01'14.2"S 22°41'51.5"E

## ACCESS DIRECTIONS

- Light aircraft transfers from Kasane (1hr 25 mins) and Maun (40 min) airports;
- Private Air charter access available;
- Duba Plains Camp is a 5-minute drive from its airstrip;
- Airstrip co-ordinates are: S19° 1' 3.45" E22° 42' 11.90;
- Airstrip length: 1000m



## ACTIVITIES

### Safari Drives

Early morning, late afternoon/ evening or even full day safari drives take place in some of Botswana's best-adapted vehicles. Duba Plains Camp's Toyota Land Cruisers are uniquely designed to traverse the floodplains. We choose to accommodate four guests (or two couples) on a safari vehicle; however, if a family or group travels together, we would easily accommodate up to six guests. Our vehicles also have fridges stocked with drinks and snacks, ready for longer days out if the wildlife viewing is exciting and just too hard to leave.

Every day is different on safari. Safari Drives often start at sunrise, returning to camp for a late breakfast and departing again mid-afternoon after tea before returning just after sunset. However, guests can often spend the entire day out in the veld with a packed breakfast, lunch, and beverages if they wish. Our safaris will often continue into the night in search of nocturnal species. Night drives are incredibly prolific, and while they take patience, sightings commonly include lesser-known nocturnal mammals and even lion and hyena hunts.

Our schedule is flexible, and guests are encouraged to create their own itinerary according to their interests with guidance and recommendations from our professional guides.

### Guided walks

Our guides are keen walking and birding specialists and therefore encourage guests to experience everything we have to offer.



# DUBA PLAINS CAMP

DUBA PLAINS CONCESSION | NORTHERN BOTSWANA



## Photography

- The customised Land Cruisers are open-sided, canopied and customised for photographers (raised roofs, photographic bars, multi-plug inverters);
- Custom built boat offering fixed camera mounts and swivel chairs specifically allowing for enhanced wildlife photographic opportunities from the water channels;
- Because we focus on photographic safaris, each of Duba Plains' guest suites has a professional camera set, including a camera body and lenses. Photos will be downloaded to a USB flash stick on guest's departure. Each suite comes with a pair of high-quality binoculars for guest use as well.

## Boating

The flat-bottomed, aluminium boat at Duba Plains allows guests to explore the papyrus flanked channels of the Okavango Delta. Enjoy the amazing birdlife seen, or the occasional elephant or other wildlife seen on the banks. Marvel at the clear, cool water flowing under you and marvel at the journey that this life sustaining liquid undertakes. It has been said that a splash of Okavango Delta water unlocks unknown flavours and aromas from one's favourite whiskey. Boating is subject to water levels.

## Fishing

A rod/reel kit is available for those who want to try their cast in the Delta between March and December on a catch and release basis - water level dependent.

## Mekoro

Explore the Okavango Delta's permanent channels by mekoro (when water levels allow). This is truly a refreshing yet peaceful experience allowing for wildlife and bird viewing from a unique perspective.

## Private vehicle option

Available for more flexibility upon request at extra cost, not compulsory for families travelling with children.

## Private Guides

Private guides are encouraged and welcomed.

## Scenic Flight and Champagne Stop

Enjoy an aerial viewing experience with great scenery across the northern part of the Okavango Delta. Add a 15-minute champagne stop on palm island en route. Must be booked in advance and is subject to extra cost and availability.

## CENTRAL FACILITIES

- Main area includes a media centre, wine cellar, interactive kitchen, dining area, lounge and library;
- Coffee/tea station;
- Large deck leading to a raised deck with additional outdoor dining space and fire pit with seating;
- Great Plains Safari Boutique selling locally and regionally produced crafts, many of which support local community projects in the nearby Okavango panhandle. The Boutique also stocks the d&nb clothing line: Dereck and Beverly Joubert have inspired this bespoke range of clothing they typically wear, and which is perfect and cool while on safari yet elegant when in the city. All materials are responsibly sourced. Visit [www.greatplainsconservation.com/safariboutique](http://www.greatplainsconservation.com/safariboutique)



# DUBA PLAINS CAMP

DUBA PLAINS CONCESSION | NORTHERN BOTSWANA



## FOOD AND BEVERAGE

- Our world-class meals are Relais & Châteaux recognised;
- All meals included and prepared by our Executive Chefs and their teams;
- All drinks and beverages are included, including imported spirits and champagnes;
- Group meals and/or individual tables, a la carte menu options;
- Indoor and outdoor dining;
- Private dining on guest's private verandah available on request;
- All dietary requirements are catered for from regular to vegan to children - prior notice required;
- We are extremely flexible on timings. Picnic breakfasts or lunch (or both) are the norm due to very active safari drives, often delivered to the bush!

## ACCOMMODATION DETAILS

### Bedroom features

- The five luxurious suites, each on raised, wrap around railway sleeper private decks and under light coloured canvas, offers guests a total footprint of approximately 242m<sup>2</sup>;
- Private outdoor plunge pool;
- Bar fridge with drinks of choice;
- Tea/Coffee station;
- Oversized double beds with mosquito nets, as well as fly netting on all suite sides;
- Singular environmentally friendly air-conditioner over the guest's bed area;
- Standing fan;

- The Duba Plains Suite is a 2-bedroom private accommodation unit with private pools - separate fact sheet available;
- Suites can be configured as double or single accommodation.

### Bathroom features

- En-suite with flush toilet, shower (indoor and outdoor), double basins;
- Luxury baths;
- Hot and cold running water;
- Soap, shampoo, conditioner, lotion and hairdryers provided.

## ACCOMMODATING CHILDREN AND SHARING ACCOMMODATION

- We look forward to having children stay with us that are 6 years and older;
- Triples for children sharing with adults can be arranged upon request;
- The 2 bedroomed Duba Plains Suite is ideal for families staying at Duba Plains;
- Families with children may be accommodated in the same vehicle as other guests unless a private safari vehicle is booked prior to arrival;
- Scheduled wildlife viewing activities, including safari drives, guided walks, and power boating, are available to guests from 6 years when accompanied by their parents or guardians. Where available, canoe and mokoro activities specifically welcome guests aged 8 years and above;





# DUBA PLAINS CAMP

DUBA PLAINS CONCESSION | NORTHERN BOTSWANA

- Young children must be supervised as the camp is open with high predator densities in and around camp and there is water surrounding camp. The camp also features raised decks and pools which are not covered;
- Great Plains Young Explorers program – thoughtfully designed to explore a range of experiences and topics from birding to cooking to art to tracking wildlife.

## SPA TREATMENTS

In-room massages are available at an additional cost.

## FITNESS

- Spinning bicycle available on request;
- Yoga mat, light weights available in each suite.

## LAUNDRY

- Included in nightly tariff - next day service, weather permitting;

## POWER AND COMMUNICATION

### Power

- The camp is solar powered with generator back-up;
- The system produces 220V, 24-hour electricity to the suites and main area;
- Plug points in each suite;
- Type of plug: South African round and international plug adapters are also available in the suites.

## INTERNET & MOBILE

- Wi-Fi in guest suites is available;
- No mobile reception.

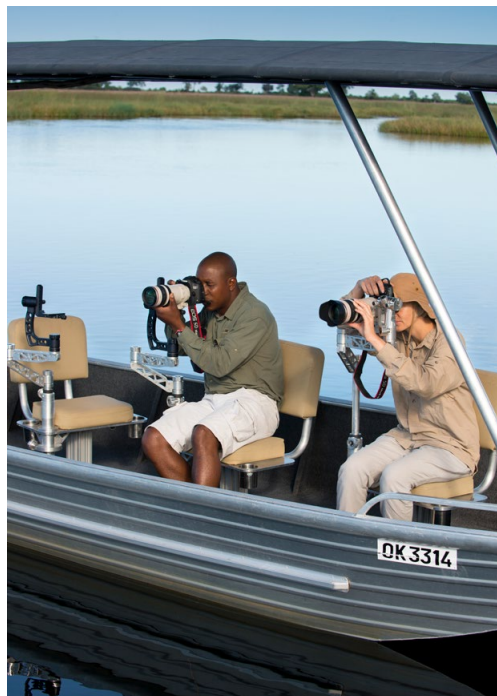

## HEALTH AND SAFETY

### Health

- Malaria: Minimal exposure risk– Malaria prophylaxis are recommended if guests are concerned; however, this is a remote area with little occurrence;
- Guests must hold comprehensive medical insurance and emergency evacuation insurance;
- Senior staff all has first aid training;
- Nearest decent medical facility is in Maun, and then Johannesburg.

### Possibility of Disabled access

- The camp layout is ideal for guests with walking challenges or who are wheelchair-bound due to the compacted earth pathway between the main area and the suites;
- The suite closest to the main area offers a ramp to access the suite from the pathway. The outside deck, sala, indoor lounge, bedroom and indoor bathroom areas are all on one level. A removable ramp is also available to allow guests access to the sunken pool deck area of the suite;
- Access to the main area is possible via a ramp for guests with walking challenges or who are wheelchair-bound;



# DUBA PLAINS CAMP

DUBA PLAINS CONCESSION | NORTHERN BOTSWANA



## Safety

- This remotely located camp is unfenced to wild animals that do move through the property especially at night;
- Fire extinguishers in every suite.

## MONEY MATTERS

### Safes

Provided in every suite.

### Accepted Payment on Location

- Staff gratuities can be paid by credit card or in Botswana Pula, South African Rands, US Dollars (2004 bills or later only) or GB Pounds;
- Guest extras and curio sales can be settled by Visa and MasterCard credit cards (No Amex or Diners).

The Team

Lodge Owners

**Great Plains Conservation**

## FOUNDATION INITIATIVE

### Rhinos Without Borders

In 2015, a rhino was poached every 6.3 hours in South Africa. In response to this crisis, Great Plains Conservation rallied various travel industry stakeholders to join forces with us and primary partner, andBeyond, to commit to increasing the Botswana population by 100 rhinos from poaching hot zones in South Africa to safe havens in Botswana. By moving 87 rhinos in and with the 63 additional calves born we exceeded expectations and achieved our goal. Now we must protect them, so we have made a transition from relocating rhinos to monitoring and protecting them in the face of a new wave of poaching continent-wide. Learn more about our efforts to save some of the last 20,000 rhinos left on the planet:

[www.greatplainsfoundation.com](http://www.greatplainsfoundation.com)

In addition to our own programs Great Plains Foundation keeps a list of school needs in the countries where we work. Needed items can be hand-carried by travelers or we can help purchase them locally. To learn more or to help support students and educators as part of your trip please reach out [info@greatplainsfoundation.com](mailto:info@greatplainsfoundation.com)



# GUEST SUITE

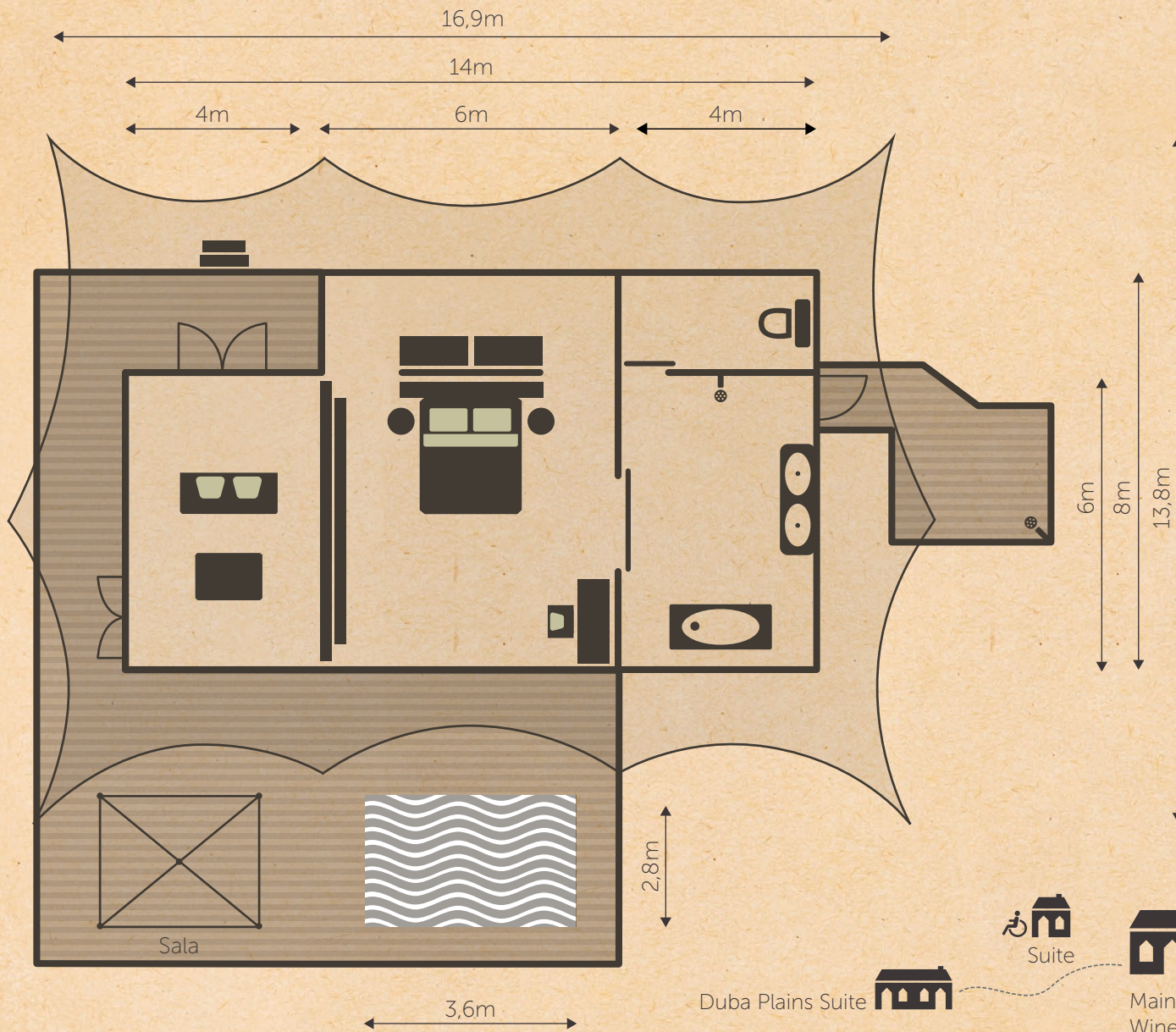



# DUBA PLAINS SUITE

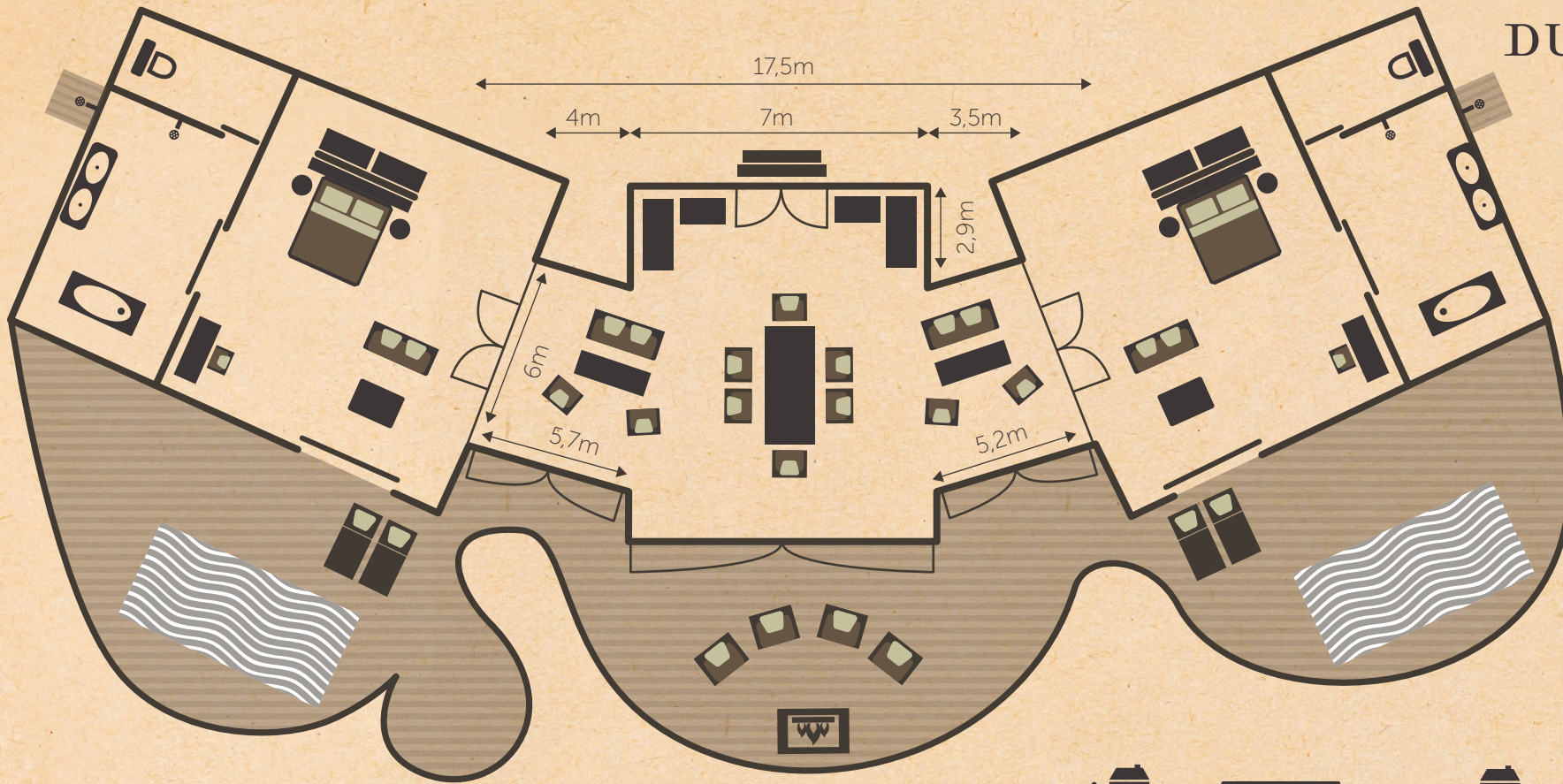





*Namibia*

*Bwabwata National Park*

*Mudumu National Park*

Kasane

*Chobe Forest Reserve*

*Chobe National Park*

Selinda Explorers Camp

Selinda Camp & Selinda Suite

Zarafa Camp & The Dhow Suite at Zarafa

Okavango Explorers Camp

*Selinda Spillway*

Sitatunga Private Island & Suite

Duba Explorers Camp

Duba Plains & Duba Plains Suite

Moremi Game Reserve

*Okavango Delta*

*Botswana*

Maun

*Nxai Pan National Park*

# GREAT PLAINS

CONSERVING AND EXPANDING NATURAL HABITATS



GREAT PLAINS CONSERVATION STRIVES TO FIND THE RIGHT FORMULA OF CONSERVATION, COMMUNITIES AND COMMERCE THAT MAKES A LASTING, SUSTAINABLE DIFFERENCE TO THE WORLD'S ICONIC WILDLIFE AND WILDERNESSES.



### BOTSWANA CAMPS

ACTIVITY	ZARAFA CAMP & THE DHOW SUITE AT ZARAFA	SELINDA CAMP & SELINDA SUITE	DUBA PLAINS CAMP & DUBA PLAINS SUITE	SITATUNGA PRIVATE ISLAND & SITATUNGA PRIVATE ISLAND SUITE
Camp Classification	Réserve Collection	Réserve Collection	Réserve Collection	Réserve Collection
Location	Selinda Reserve	Selinda Reserve	Duba Plains Concession	Sitatunga Private Reserve
Size of concession / reserve	130 000 Hectares / 321 237 Acres	130 000 Hectares / 321 237 Acres	33 000 Hectares / 81 500 Acres	Not relevant
Number of Suites / Tents	4 Suites	3 Suites	5 Suites	2 Suites
Family Accommodation	The Dhow Suite at Zarafa	The Selinda Suite	The Duba Plains Suite	The Sitatunga Private Island Suite
Children can be accommodated from:	6 Years	6 Years	6 Years	6 Years
Day and Night Safari Drives	Yes	Yes	Yes	Day drives possible
Private Activities (at an additional charge)	Yes (Included for Dhow Suite)	Yes (Included for Selinda Suite)	Yes (Included for Duba Plains Suite)	Private boating & walking activities (Included for the Sitatunga Private Island Suite)
Guided Walks	Yes	Yes	Yes	Yes
Boating (*water level dependent)	*Yes	*Yes	Yes	Yes
Mekoro and/or Canoeing (*water level dependent)	n/a	n/a	Mekoro	*Mekoro
Fishing (Seasonal and *water lever dependent)	*Yes	*Yes	Yes	Yes
Scenic Flights and Champagne Stops	Available at an additional charge	Available at an additional charge	Available at an additional charge	Available at an additional charge
Main Swimming Pool / Private Plunge Pools	Private Plunge Pool	Private Plunge Pool	Private Plunge Pool	Private Plunge Pool
Shower	Indoor & Outdoor	Indoor	Indoor & Outdoor	Indoor
Bath	Yes	Yes	Yes	Yes
Hairdryers (low-voltage)	Yes	Yes	Yes	Yes
Mosquito Nets	Yes	Yes	Yes	Yes
Eco cooling system over bed	Yes	Yes	Yes	Yes
Fan	Yes	Yes	Yes	Yes
Wi-Fi – in-room (complimentary)	Yes	Yes	Yes	Yes
Safe - In-room	Yes	Yes	Yes	Yes
Spa treatments (at an additional charge)	Yes	Yes	Yes (In-room only)	Yes (In-room only)
Fitness	Gym & In-Room Equipment	In-Room Equipment	In-Room Equipment	In-Room Equipment
Boutique on site	Yes	Yes	Yes	Yes



## BOTSWANA CAMPS

ACTIVITY	SELINDA EXPLORERS CAMP	OKAVANGO EXPLORERS CAMP	DUBA EXPLORERS CAMP
Camp Classification	Explorers Collection	Explorers Collection	Explorers Collection
Location	Selinda Reserve	Selinda Reserve	Duba Plains Concession
Size of concession / reserve	130 000 Hectares / 321 237 Acres	130 000 Hectares / 321 237 Acres	33 000 Hectares / 81 500 Acres
Number of Suites / Tents	3 Tents	6 Tents	5 Tents
Family Accommodation	1 Family Tent	n/a	n/a
Children can be accommodated from:	6 Years	6 Years	6 Years
Day and Night Safari Drives	Yes	Yes	Yes
Private Activities (at an additional charge)	Yes	n/a	Yes
Guided Walks	Yes	Yes	Yes
Boating (water level dependent)	n/a	n/a	Yes
Mekoro and/or Canoeing (water level dependent)	Canoeing	Canoeing	Mekoro
Fishing (Seasonal and water lever dependent)	Yes	Yes	Yes
Scenic Flights and Champagne Stops	Available at an additional charge	Available at an additional charge	Available at an additional charge
Main Swimming Pool / Private Plunge Pools	Main Swimming Pool	n/a	Main Swimming Pool
Shower	Indoor	Indoor	Indoor
Bath	n/a	n/a	n/a
Hairdryers (low-voltage)	n/a	n/a	n/a
Mosquito Nets	On All Tent Sides	Yes	Yes
Eco cooling system over bed	n/a	n/a	n/a
Fan	Yes	Yes	Yes
Wi-Fi – in-room (complimentary)	Yes	Yes	Yes
Safe - In-room	Yes	Yes	Yes
Spa treatments (at an additional charge)	n/a	n/a	n/a
Fitness	Yoga Mats	Yoga Mats	In-Room Equipment
Boutique on site	n/a	n/a	Yes